



## TC-A3563 Spec:44X/I/A

PTZ Camera

Pro Series



### KEY FEATURES

- Up to 2560×1440@25fps
- Color: 0.0008lux@ (F1.6, AGC ON), B/W: 0lux with IR
- S+265/H.265/H.264/M-JPEG
- Optical Zoom 44X
- IR Range Up to 180m
- Built-in Micro SD card slot, up to 512 GB
- Support Smart surveillance, Capture facial images
- Support Human/Vehicle Classification
- Operating Conditions -30°C~70°C(IR OFF) -30°C~40°C(IR ON), 0~95%
- AC24V±15%
- IP66



Tiandy Technologies Co.,Ltd



Tiandy Overseas



Tiandy



@tiandyofficial

**Tiandy Technologies Co.,Ltd.**

Email: [sales@tiandy.com](mailto:sales@tiandy.com)

Tel: +86-22-58596065

Website: [en.tiandy.com](http://en.tiandy.com)

Fax: +86-22-58596048

## SPECIFICATIONS

Camera	
Image Sensor	1/1.8"CMOS
Min. Illumination	Color: 0.0008lux@ (F1.6, AGC ON), B/W: 0lux with IR
Shutter Time	1s~1/100000s
Day&Night	IR-cut filter with auto switch (ICR)
WDR	120dB
Lens	
Focal Length	6mm~264mm
Optical Zoom	44X
Digital Zoom	16X
Zoom Speed	<6s
Aperture Range	F1.6~F5.3
Field of View	61.8°~2.3°(H); 36.3°~1.3°(V); 69°~2.6°(D)
Focus Control	Auto/Semi-auto/Manual
Iris Control	Auto
Close Focus Distance	100mm~1000mm
DORI Distance	Detect:2533m Observe:1005m Recognize:506m Identify:253m
Pan&Tilt	
Pan Range	360°
Tilt Range	-16°~90° (Default -3°~90°)
Tilt Speed	Manual Speed:0.1°~120°/s Preset: 180°/s
3D Position	Yes
Preset	500
Cruise	16, up to 32 presets per cruise
Scan	8
Pattern	8, each with 600s memory or 1000 orders
Scheduled Task	Preset、Cruise、Scan、Pattern
North Point	Yes(Manual setting)
Power-off Memory	Yes
Preset Freezing	Yes
Illuminator	
IR LEDs	8
IR Distance	Up to 180m
Wavelength	850nm
IR Irradiation Angle	Adjustable by Zoom
White LEDs	2
Whitelight Distance	30m
Compression Standard	
Video Compression	S+265/H.265/H.264/M-JPEG
Video Bit Rate	32Kbps~16Mbps

Audio Compression	G.711A/G.711U/ADPCM_D/AAC_LC
Audio Sampling Rate	8KHz/32KHz/48KHz
<b>Image</b>	
Max. Resolution	2560×1440@25fps
Main Stream	PAL:20fps(3072×1728), 25fps(2560×1440, 2304×1296, 1920×1080, 1280×960, 1280×720, 640×480, 704×576) NTSC:20fps(3072×1728), 30fps(2560×1440, 2304×1296, 1920×1080, 1280×960, 1280×720, 640×480, 704×480)
Sub Stream	PAL:25fps(704×576, 640×360, 704×288, 352×288) NTSC:30fps(704×480, 640×360, 704×240, 352×240)
Third Stream	PAL:25fps(704×576, 704×288, 352×288) NTSC:30fps(704×480, 704×240, 352×240)
BLC	Yes
HLC	Yes
AGC	Yes
White Balance	Yes
ROI	7 rectangular 3D fixed focus areas, supporting 1 rectangular dynamic tracking ROI
EIS	Yes
OSD	5 regions(Each region can have a maximum of 127 characters,up to 5 lines); 16*16/24*24/32*32/48*48/64*64/96*96/adaptable size; Vector/Lattice
Defog	Yes
Flip	Normal/Inverted Flip
Regional Exposure	Yes
Regional Focus	Yes
Demist	Yes
Privacy Mask	24 regions
<b>Feature</b>	
Alarm Trigger	Motion Detection; Mask Alarm; Disk Full; Disk R/W Error; IP Address Conflict; MAC Address Conflict; FTP Server Exception ; Event Input,Event Output; Network cable disconnected
Linkage Method	send email; trigger sound; trigger warmlight; trigger recording; trigger capture; notify surveillance center
Video Analytics	Human/Vehicle Classification; Tripwire; Double Tripwire; Perimeter; Object Abandon; Object Lost; Heatmap; Loitering; Running; People Counting; Crowded; Safety Helmet Detection; On Duty Detection; Video Abnormal; Audio Abnormal
Early Warning(EW)	Early Warning(EW)
Auto-Tracking	Auto-Tracking
Face Mode	Capture facial images
<b>Network</b>	
ANR	ANR
Protocols	HTTP; HTTPS; TCP/IP; UDP; UPnP; ICMP; IGMP; SNMP v1; DHCP; DNS; DDNS; NTP; SMTP; TLS; SSL; QoS; IPv4; IPv6; PPPOE; Unicast; Multicast; ARP; RTP; RTSP; FTP; PING
System Compatibility	ONVIF Profile S/T/G; CGI
Remote Connection	≤7

User/Host	Up to 8 users. 4 user levels
Client	Easy7 Smart Client
Moblie Client	EasyLive Plus
<b>Interface</b>	
Communication Interface	1*RJ45 10M/ 100M self adaptive Ethernet port
Audio I/O	1*Input Impedance 1k $\Omega$ ,2.0~2.4Vp-p; 1*Output Impedance 600 $\Omega$
Alarm I/O	8,Switching; 2,Switching,Voltage $\leq$ DC24V,Current $\leq$ 1A
Reset Button	Yes
On-board storage	Built-in Micro SD card slot, up to 512 GB
RS-485	RS485
Wiper	Yes
<b>General</b>	
Web Client Language	16 languages Simple Chinese/English/Traditional Chinese/Spanish/Italian/ Korean/Turkish/Russian/Thai/ Polish/French/Dutch/ Hebraism/Vietnamese/Arabic/Farsi
Operating Temperature	-30 $^{\circ}$ C~70 $^{\circ}$ C(IR OFF) -30 $^{\circ}$ C~40 $^{\circ}$ C(IR ON)
Operating Humidity	0~95%
Storage Temperature	-40 $^{\circ}$ C~70 $^{\circ}$ C
Storage Humidity	0~95%(non-condensing)
Power Supply	AC24V $\pm$ 15%
Protection	Surge protection 4000V; Lightning proof 6000V; IP66
Material	Metal
Boundary Dimensions	222mm(D)x372mm(H)
Package Dimensions	320(L)*320(W)*520(H)mm
GrossWeight	8.9Kg
NetWeight	5.45Kg

DIMENSIONS (Unit: mm)

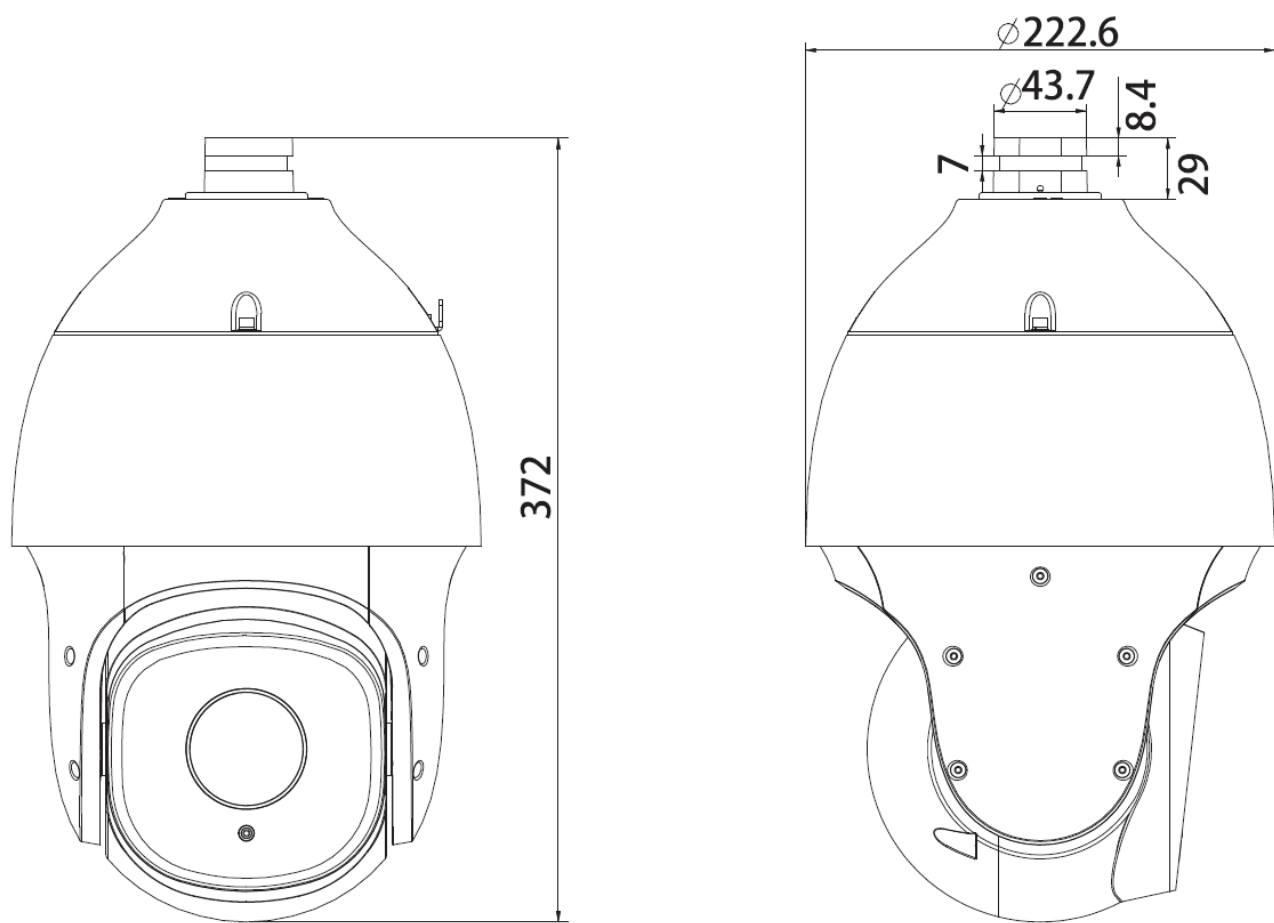

Assembly diagram of Junction Box

